



Project: _____

Item: _____

Quantity: _____

Date: _____

Models	Length
<input type="checkbox"/> CP-ST-MF-28	28 ^{3/8"}
<input type="checkbox"/> CP-ST-MF-36	36 ^{3/8"}
<input type="checkbox"/> CP-ST-MF-50	50 ^{3/8"}
<input type="checkbox"/> CP-ST-MF-60	60 ^{3/8"}
<input type="checkbox"/> CP-ST-MF-66	66 ^{3/8"}
<input type="checkbox"/> CP-ST-MF-74	74 ^{3/8"}
<input type="checkbox"/> CP-ST-MF-84	84 ^{3/8"}
<input type="checkbox"/> CP-ST-MF-96	96 ^{3/8"}

Standard Features

- ✓ 30" wide 14 gauge stainless steel top
- ✓ Molded fiberglass body
- ✓ Open Storage Base
- ✓ 5" Locking Swivel Casters
- ✓ Cam Operated Line-up Locks

CP-ST-MF-36



- Most versatile counters, add the options you need!
- Durable, colorful, molded fiberglass
- Easy to clean, low maintenance

Specifications

Top - Top to be 30" wide and fabricated from a minimum of 14 gauge stainless steel with square turndown on all sides and corners fully welded, ground and polished. Top to have #4 satin finish.

Body (MF) - Body to be seamless molded fiberglass F.R.P.) with smooth exterior surfaces and rounded corners. To be constructed by a hand lay-up process with four layers of 1.5 oz continuous strand fiberglass mat, plus a 24 oz layer of woven roving on the bottom for added strength. Fiberglass to be

flame retardant per specification ASTM E-162 having a flame spread of 25% or less. Body interior to be reinforced at each end with 4 wide, 12 gauge galvanized uprights welded to support shelving to form integral U frame for maximum stress relief.

Options

Top Options

- Height Other Than Standard 36" (Specify ____)
- (MR)#7 Hi-Lite Edge
- (TWE) Top Width Extension (Specify _____)
- 3" knock out W/ grommet

Above the Top

- (CCCP) CrystalClear Counter Protector
- (CCSB) CrystalClear Self-Service Single Buffet Shield
- (CCDB) CrystalClear Self-Service Double Buffet Shield
- (CCCPADJ) CrystalClear Counter Protector Adjustable from Self-Service to Full-Service
- (CCSMT) Crystal Clear Multi-Tier Single Service
- (CCDMT) Crystal Clear Multi-Tier Double Service
- (F) Overshelf 16 Ga. Stainless Steel Top Shelf Mounted On 1-1/4" tubular uprights
- (GA) Sloped Front Protector, Stainless Steel Top, Adjustable
- (GAG) Sloped Front Protector, Glass Top Shelf, Adjustable
- (GC) Sloped Front Protector, Stainless Steel Top, Fixed Glass

- (GCG) Sloped Front Protector, Glass Top Shelf, Fixed Glass
- (M) Buffet Shield Single Service Hinged
- (N) Buffet Shield Double Service Hinged
- (I) 2 Tier Display Shelf, Single Service
- (I2) 2 Tier Display Shelf, Double Service
- (RR) LED Lights
- (S) Heat Lamp
- (U) Heat Lamp with Lights

Tray Slide/Cutting Boards

- (A) 10" Beaded, Stainless Steel Tray Slide
- (B) 10" Flat Surface, Stainless Steel Tray Slide
- (C) 10" Tubular Tray Slide
- (CTS) 10" Corian Tray Slide Solid
- (CTR) 10" Corian Tray Slide Routed Runners
- (D) 6" Wide Stainless Steel Cutting Board
- (E) 6" Wide Richlite® Composite Cutting Board
- (E1) 6" Sanalite® Cutting Board
- (FF) End Drop Shelf 12" x 30"

Base Options

- (EB) Enclosed Base - No Under Storage
- (Y) Hinged Doors
- (BB) Heated Storage Base
- (MM) Vertical Trim Strips
- (SS) Stainless Steel Legs
- (TK) S/S Toe Kick
- (CL) Cylinder Locks

Plumbing & Electrical Options

- (DD) Convenience Outlet, Flush
- (DC) Daisy Chain Outlet

Solid Top Serving Counter

Molded Fiberglass (MF)



Solid Top Serving Counter
Molded Fiberglass (MF)

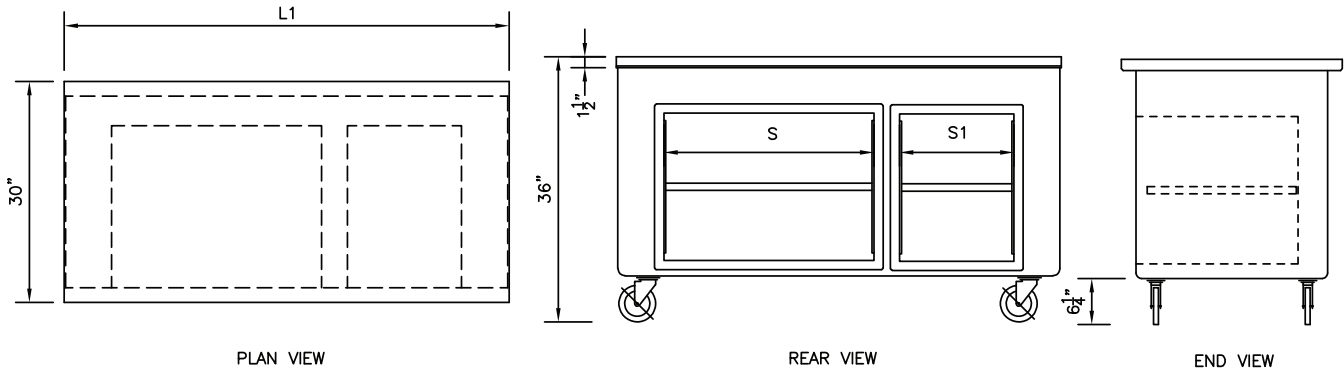

Model	L	S	S1	Approx. Ship Weight
CP-ST-MF-28	28 3/8"	15"	N/A	205 lbs.
CP-ST-MF-36	36 3/8"	15"	N/A	220 lbs.
CP-ST-MF-50	50 3/8"	28"	N/A	260 lbs.
CP-ST-MF-60	60 3/8"	28"	15"	300 lbs.
CP-ST-MF-66	66 3/8"	28"	15"	320 lbs.
CP-ST-MF-74	74 3/8"	28"	28"	340 lbs.
CP-ST-MF-84	84 3/8"	28"	28"	360 lbs.
CP-ST-MF-96	96 3/8"	28"	28"	380 lbs.

Décor Options (Contact Factory)

- Vinyl Graphic
- Over-Structure With Signage & Lights
(Specify _____)
- Stand Off Panel
(Specify Materials _____)

We reserve the right to change specifications and product design without notice. Such revisions do not entitle the buyer to corresponding changes, improvements, additions or replacement for previously purchased equipment.

All equipment to be built in accordance with the Underwriters Laboratories, Inc. and the National Sanitation Foundation, Inc. standards and shall bear the Underwriters Laboratories, Inc. listing label for safety and the Underwriters Laboratories classification label for sanitation.

A.I.A. File No. 00-0-00

SIS No. 00-0-00

REV 9/4/24

LTI, Inc.
1947 Bill Casey Parkway
Jonesboro, GA 30236

(888) 584-2722
lowtempind.com



Changing
how food is served.™