



SimplicitySeries utilizes in stock and ready-to-release components that have shorter lead times.

Project: _____

Item: _____

Quantity: _____

Date: _____

Models

- SIM-CSE-28
- SIM-CSE-36

Standard Features

- ✓ 30" wide 14 gauge stainless steel top
- ✓ Tubular footrest
- ✓ 5" Locking Swivel Casters
- ✓ Cam locking Line-up Lock
- ✓ 36" A.F.F.
- ✓ Shipped fully assembled
- ✓ Convenience Outlet
- ✓ Blank J-box for Data
- ✓ Locking Cashier Drawer
- ✓ NEMA 5-15 Plug

SIM-CSE-36-LP shown with options: (A) beaded stainless steel tray slide, and (HH) locking cash drawer.



- Versatile counters, add the options you need!
- Easy to clean, low maintenance

Specifications

Top - Top to be 30" wide and fabricated from a minimum of 14 ga. stainless steel with square turndown on all sides and corners fully welded, ground and polished. Top to have #4 satin finish.

Body (MF) - Body to be seamless molded fiberglass (F.R.P.) with smooth exterior surfaces and rounded corners. To be constructed by a hand laid process with four layers of 1.5 oz continuous strand fiberglass mat, plus a 24 oz layer of woven roving on the bottom for added strength. Fiberglass to be flame retardant per specification

ASTM E-162 having a flame spread of 25% or less. Body interior to be reinforced at each end with 4" wide, 12 gauge galvanized channels welded to form integral U frame for maximum stress relief.

Body (LP) - Standard grade laminate to cover all sides of an 18 gauge steel uni-body structure. Interior reinforced with 12 gauge galvanized uprights to support shelving and a 20 gauge steel bottom. Corners and bottom edge provided with 1/2 stainless steel trim strips.

Body (SS) - Uni-body structure, fabricated from 18 gauge stainless steel, welded ground and polished. Interior reinforced with 12 gauge galvanized uprights to support shelving and a 20 gauge steel bottom.

Options

Tray Slides and Work Shelves**

- (A) 10" Beaded, stainless steel tray slide
 - Single side
 - Dual side
 - (B) 10" Flat Surface, stainless steel tray slide
 - Single side
 - Dual side
 - (D) 6" deep Stainless Steel Work Shelf
 - Single side
 - Dual side
 - (FF) 12" End Mounted Drop Down Shelf
- **Mounted flush with top or 2" below top

Exterior Finishes

- Molded Fiberglass (MF)
- Stainless Steel (SS)
- Laminate over Galvanized (LP)
(Standard laminate finishes - consult factory for questions)

Mount Option

- 6" stainless steel legs with stainless steel adjustable bullet foot

Molded Fiberglass (MF) or Laminate Panel (LP) or Stainless Steel (SS) Cashier Station

A.I.A. File No. 00-0-00

SIS No. 00-0-00

REV 8/9/23

Cashier Station

Molded Fiberglass (MF) or Laminate Panel (LP) or Stainless Steel (SS)



Cashier Station
Molded Fiberglass (MF) or Laminate Panel (LP) or Stainless Steel (SS)

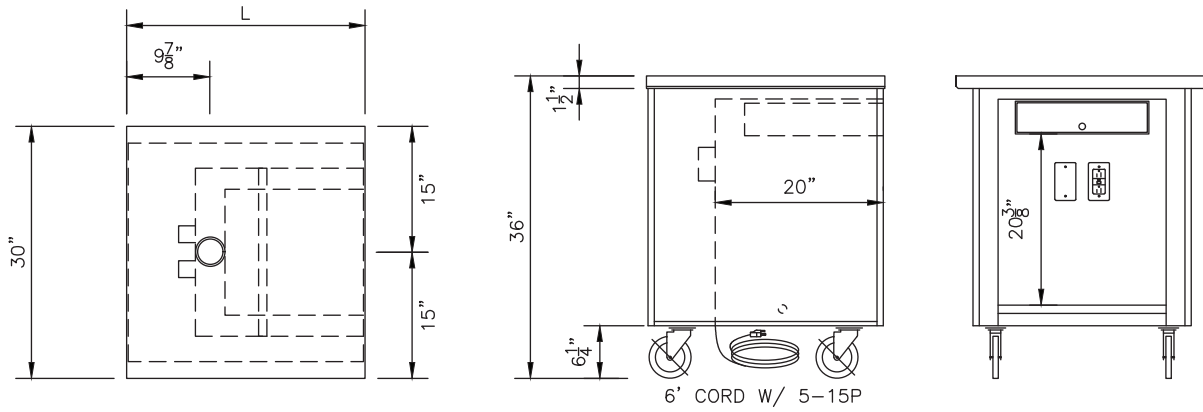

CSE Models	L	APPROX. SHIP WEIGHT
SIM-CSE-28	28 ³ / ₈ "	205 lbs.
SIM-CSE-36	36 ³ / ₈ "	260 lbs.

We reserve the right to change specifications and product design without notice. Such revisions do not entitle the buyer to corresponding changes, improvements, additions or replacement for previously purchased equipment.

All equipment to be built in accordance with the Underwriters Laboratories, Inc. and the National Sanitation Foundation, Inc. standards and shall bear the Underwriters Laboratories, Inc. listing label for safety and the Underwriters Laboratories classification label for sanitation.

A.I.A. File No. 00-0-00

SIS No. 00-0-00

REV 8/9/23

LTI, Inc.
1947 Bill Casey Parkway
Jonesboro, GA 30236

(888) 584-2722
lowtempind.com



Changing
how food is served.™